



Hall-Effect Thruster

Power support for satellite mass from 30kg to 1500kg

The HET series of thrusters allow 30 to 1500 kg of satellite to perform maintenance and change orbits in real time according to user requirements.

Key features

Products flight proven

Multi-mode operation, meet the different thrust size real-time adjustment

Enhanced antioxidant capacity

Long design life

High impulse, low cost

HET 100W

| | |
|------------------------|---|
| Steady thrust (Xenon) | 6mN~10mN |
| Steady impulse (Xenon) | 950s~1100s |
| Steady power (Xenon) | 110W~180W |
| Working hours | Accumulated working hours \geq 2500h Maximum single working time \geq 24h Switching times \geq 5500 times |
| Design life | 5~8 years |
| Impulse | \geq 54000Ns |
| Mass | 0.9kg \pm 0.05kg |
| Peak discharge power | \leq 180W |
| Start-up time | 6min \pm 1s |
| Reliability | 0.99,0.97(end of life) |

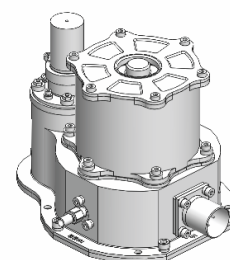
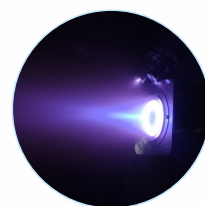
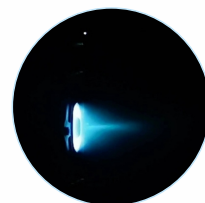

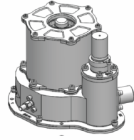

HET 200W

| | |
|--------------------------|---|
| Steady thrust (Xenon) | 10mN~16mN |
| Steady impulse (Xenon) | 1100s~1300s |
| Steady power (Xenon) | 170W~280W |
| Steady thrust (Krypton) | 11mN~16mN |
| Steady impulse (Krypton) | 1200s~1410s |
| Steady power (Krypton) | 265W~340W |
| Working hours | Accumulated working hours \geq 3500h Maximum single working time \geq 24h Switching times \geq 5500 times |
| Design life | 5~8 years |
| Impulse | \geq 126000 Ns |
| Mass | 1.0kg \pm 0.1kg |
| Peak discharge power | \leq 380W |
| Start-up time | 6min \pm 1s |

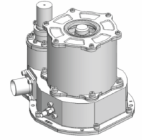

HET 300W

| | |
|--------------------------|---|
| Steady thrust (Xenon) | 18mN~20mN |
| Steady impulse (Xenon) | 1350s~1380s |
| Steady power (Xenon) | 305W~340W |
| Steady thrust (Krypton) | 15mN~18mN |
| Steady impulse (Krypton) | 1413s~1490s |
| Steady power (Krypton) | 308W~420W |
| Working hours | Accumulated working hours \geq 4500h Maximum single working time \geq 24h Switching times \geq 5500 times |
| Design life | 5~8 years |
| Impulse | \geq 243000 Ns |
| Mass | 1.1kg \pm 0.1kg |
| Peak discharge power | \leq 560W |
| Start-up time | 6min \pm 1s |



HET 700W

| | |
|--------------------------|--|
| Steady thrust (Xenon) | 36mN~40mN |
| Steady impulse (Xenon) | 1580s~1600s |
| Steady power (Xenon) | 600W~720W |
| Steady thrust (Krypton) | 33mN~40mN |
| Steady impulse (Krypton) | 1570s~1670s |
| Steady power (Krypton) | 690W~900W |
| Working hours | Accumulated working hours \geq 5500h Maximum single working time \geq 24h Switching times \geq 10000 times |
| Design life | 5~8 years |
| Impulse | \geq 720000Ns |
| Mass | 2.6kg \pm 0.1kg |
| Peak discharge power | \leq 1100W |
| Start-up time | 6min \pm 1s |
| Reliability | 0.99,0.97(end of life) |



HET 1700W

| | |
|--------------------------|--|
| Steady thrust (Xenon) | 70mN~92mN |
| Steady impulse (Xenon) | 1630s~1720s |
| Steady power (Xenon) | 1280W~1700W |
| Steady thrust (Krypton) | 62mN~80mN |
| Steady impulse (Krypton) | 1700s~1810s |
| Steady power (Krypton) | 1330W~1720W |
| Working hours | Accumulated working hours \geq 6500h Maximum single working time \geq 24h Switching times \geq 10000 times |
| Design life | 5~8 years |
| Impulse | \geq 1440000Ns |
| Mass | 4.7kg \pm 0.1kg |
| Peak discharge power | \leq 1850W |
| Start-up time | 6min \pm 1s |
| Reliability | 0.99,0.97(end of life) |

